



Patio Door Kit Assembly Instructions -- 2-Panel Patio Door with Non-Assembled Frame and Assembled Sash Panels.

(Non Handed Kits)







Project Requirements:

~ This door was manufactured for installation into either a new or existing door opening.

Note: Kit can be assembled Right or Left Handed- Just reverse the sash panels.

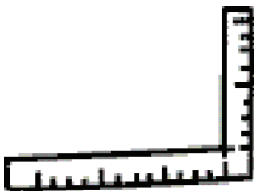
~ Door should be Approximately $\frac{1}{2}$ " less in both Width and Height than the opening.

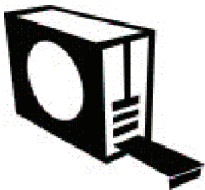
Tools & Materials required.:

 Hammer	 Slotted Hand Screwdriver	 Phillips Hand Screwdriver
 Framer's Square	 Power Driver & Bits	 Caulk Gun & Silicone
 Measuring Tape	 Work Gloves	 Safety Glasses

STEP 1

GPIMILLWORKS

Inspect Door Kit for correct size and condition and verify that all parts are included.

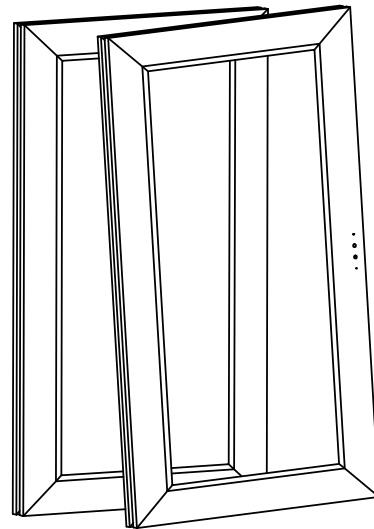
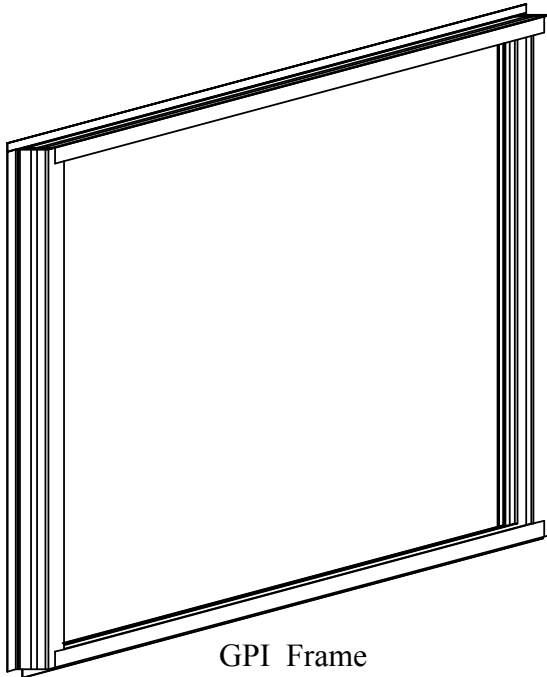

Note: Glazing by customer. Glazing beads supplied for 1" IG's

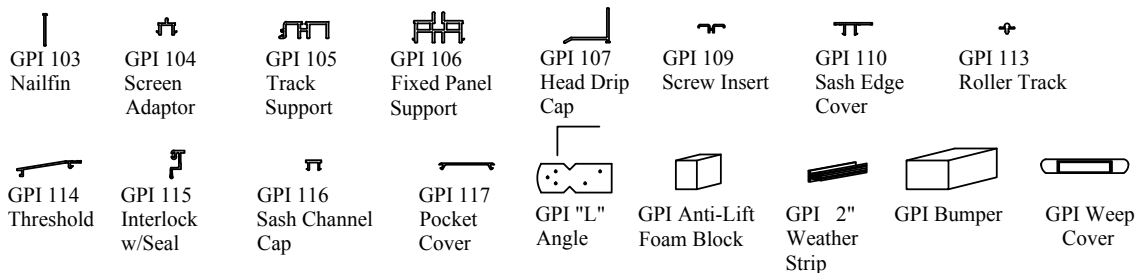

Hardware Included: -Handel Set, - Hardware pack

Hardware Pack:

5- Weeps, 4- Corner pad seals, 1- Bumper with double stick tape, 1-Bracket & foam pads, 12- Jamb screws, 10-Interlock screws with white heads, 5- Bracket screws with white heads, 5- Fixed panel screws white heads, 1 @ 6" Woolpile strip with adhesive back, 1- anti-lift block with double stick tape, 2-Square double stick pads for jamb top. 4 - Wheel adjustment Plugs.

STEP 2

GPIMILLWORKS

Assemble Patio Outer Frame

NOTE: Before assembly remove weatherstrips (x2 pls.) from inner pocket of fixed panel jamb and (x2 pls.) from outer pocket of sliding sash jamb.

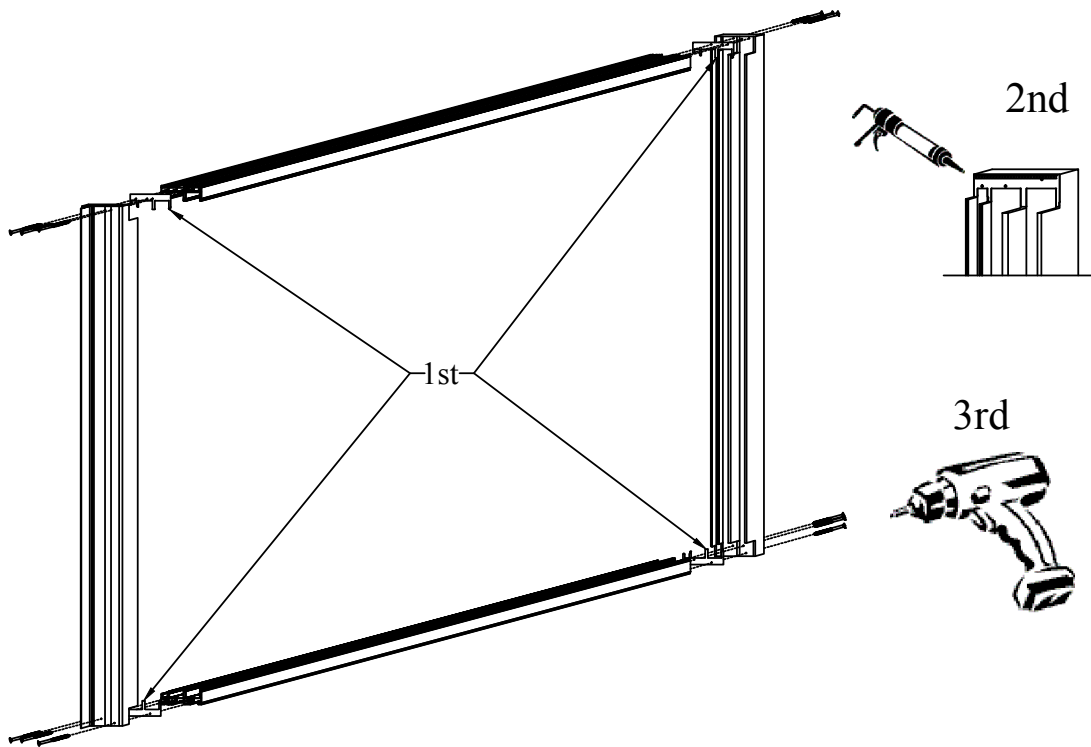

1st ~ Apply one Gasket on each end of the jamb at the sill and head.

2nd ~ Apply Sealant over foam Gasket on jambs where it will contact the sill or head.

3rd ~ Fasten using #8 x 1 3/4" Screws

STEP 3

1st ~ Repeat for remaining 3 corners.

Note: Make sure tracks line up.

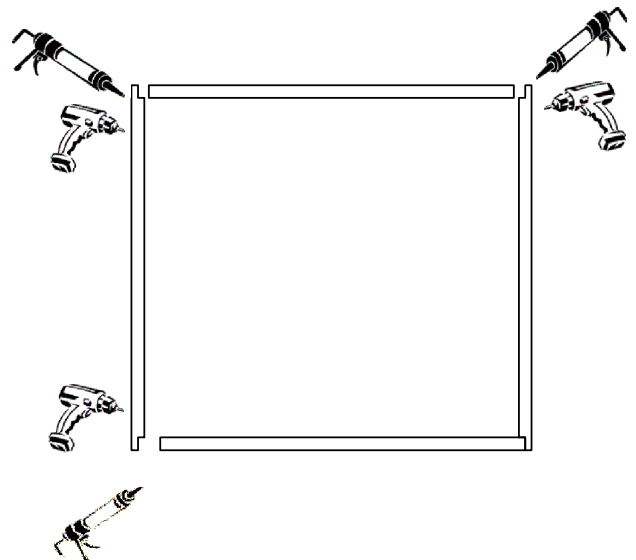

STEP 4

Add Outer Frame Components

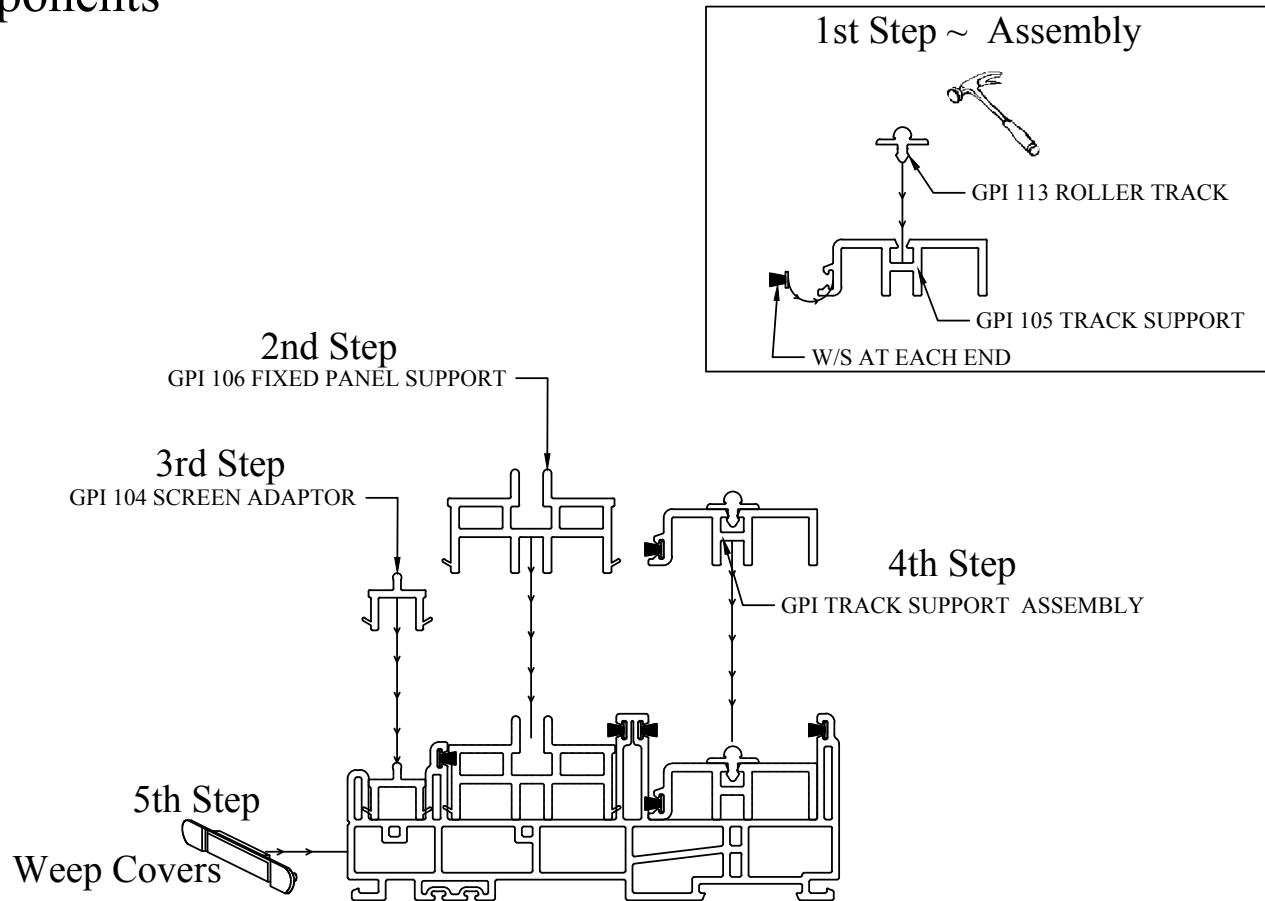

1st ~ Install Roller Track to Track Support. Along with 2 ~ 1" Weatherstrips at each end (as shown)

2nd ~ Snap in Fixed Panel Support

3rd ~ Snap in Screen Adaptor

4th ~ Snap in Track Support Assembly (from First Step)

5th ~ Snap on Weep Covers

STEP 5

GPIMILLWORKS

Fixed Sash Installation

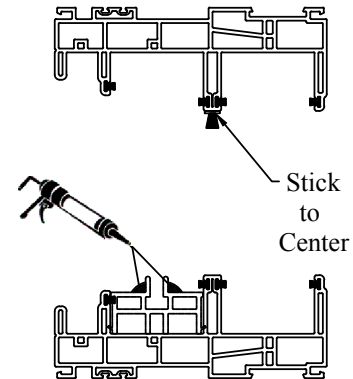
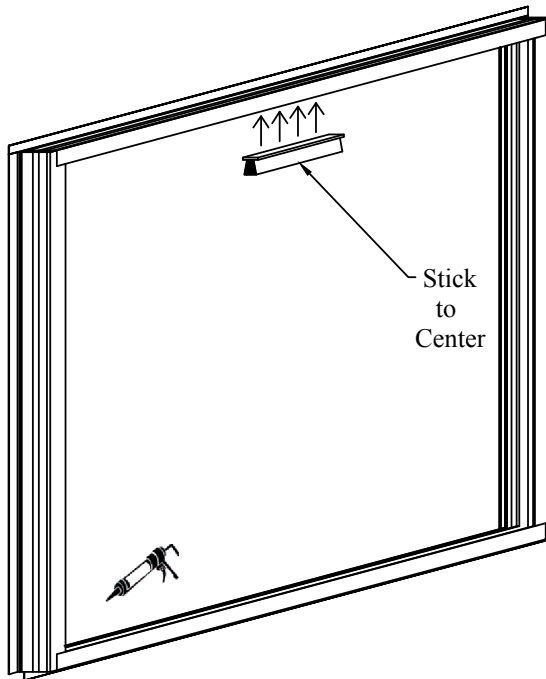

1st ~ Install Self-Adhesive Weather strip.

2nd ~ Place Beads of Silicone as shown in diagram, Under Fixed Panel.

3rd ~ Follow directions below to seat Fixed panel.

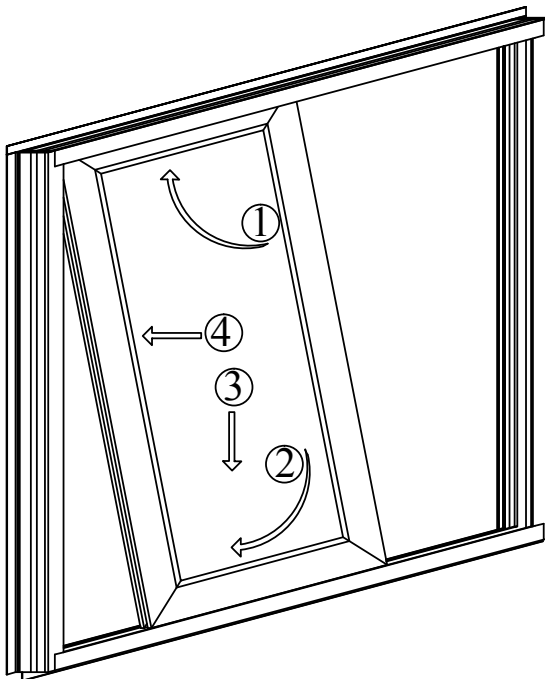

- ① Lift Fixed Panel into Head.
- ② Swing bottom into Frame.
- ③ Seat Panel into Silicone at Sill.
- ④ Slide Panel firmly into Jamb.

STEP 5

GPIMILLWORKS

Fixed Sash Installation (Continued)

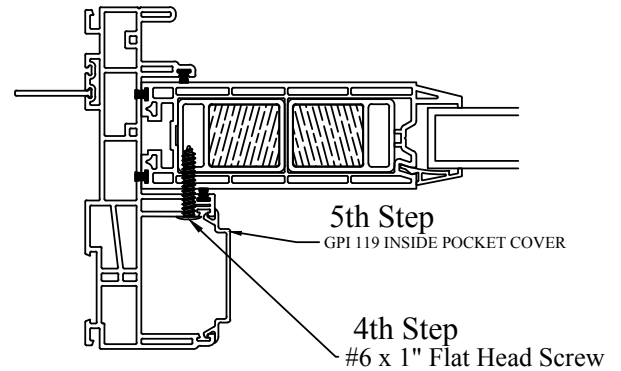
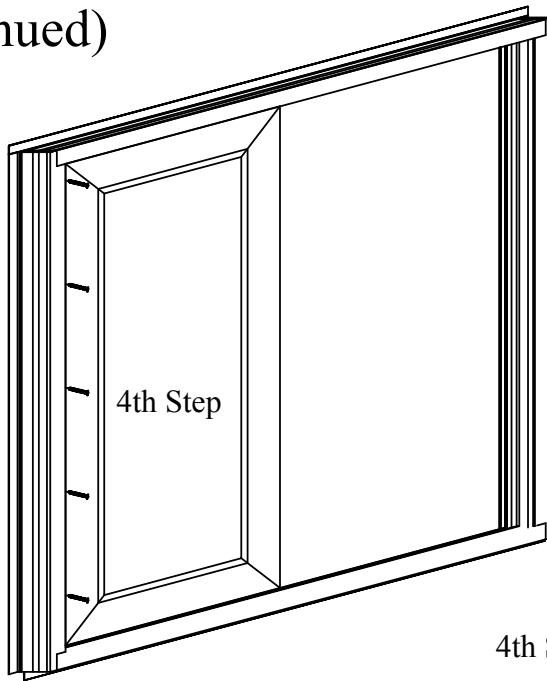

4th ~ Screw Fixed Panel in to place. (Multiple Places)

5th ~ Snap-in Inner Pocket Cover (w/s should have been removed. see step 2)

6th ~ Screw and Tape Interlock on to Fixed Panel. (Multiple Places)

7th ~ Install Foam Block & "L" Angle between Sash and Frame Head.

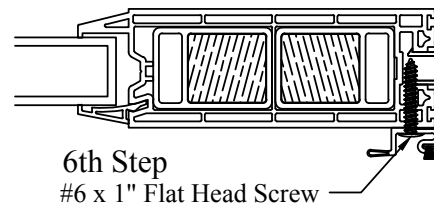
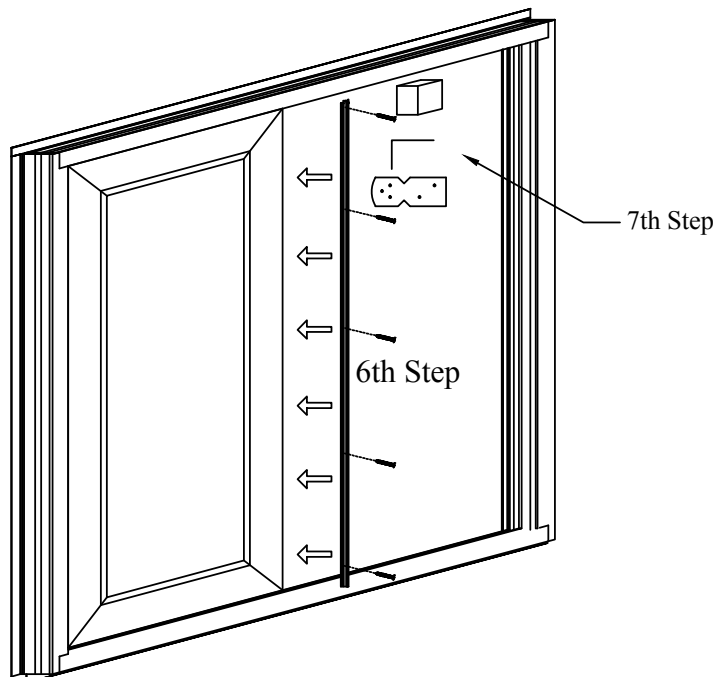

STEP 6

GPIMILLWORKS

Sliding Sash Installation

1st ~ Snap in Threshold

2nd ~ Install Sash Stop in upper corner fixed side.

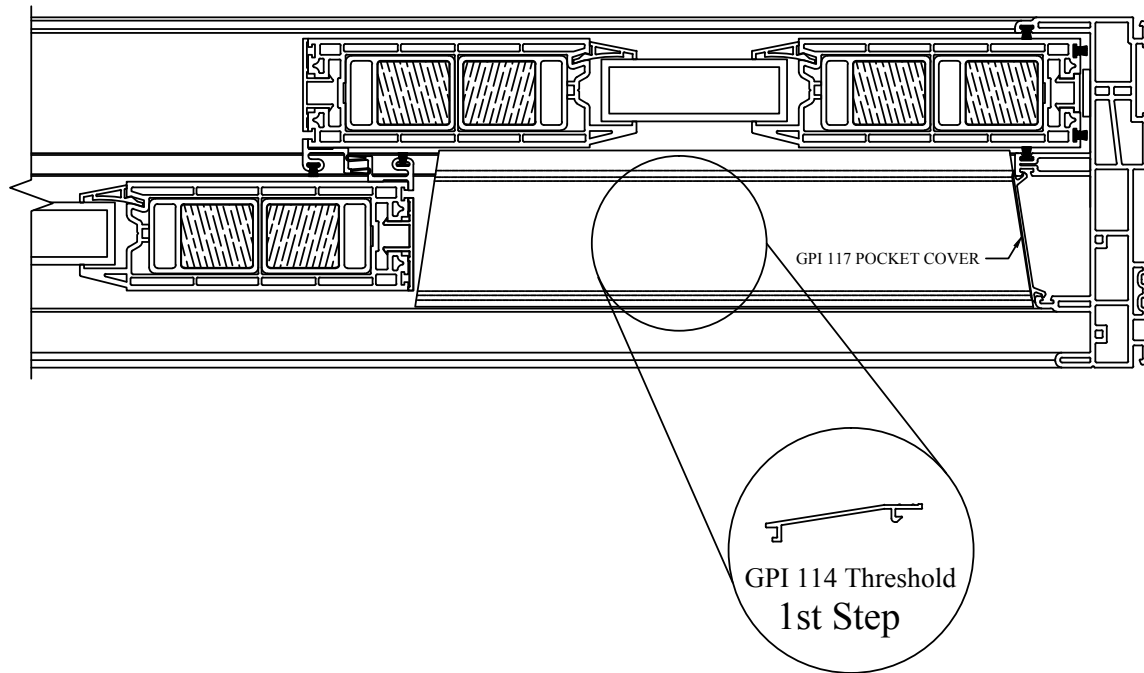

3rd ~ Install Outer Jamb pocket covers and Head pocket cover.

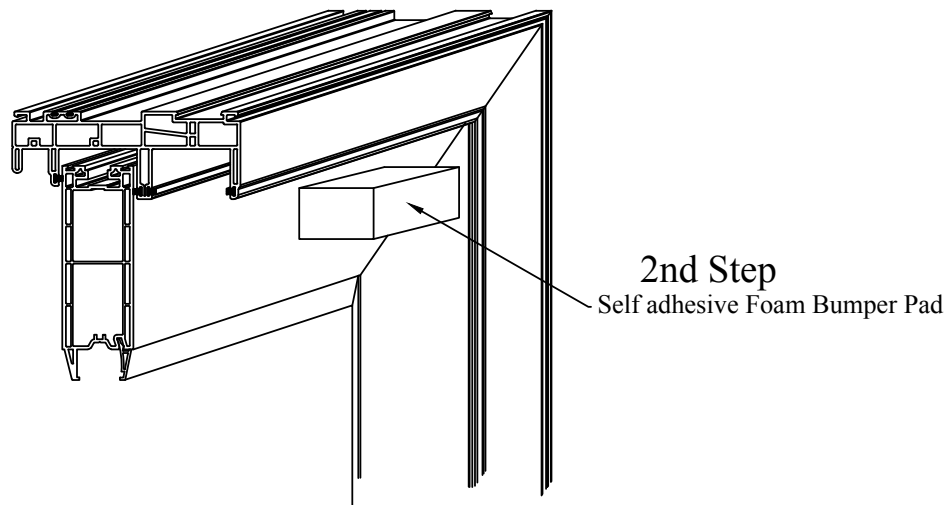

STEP 6

GPIMILLWORKS

Sliding Sash Installation (Continued)

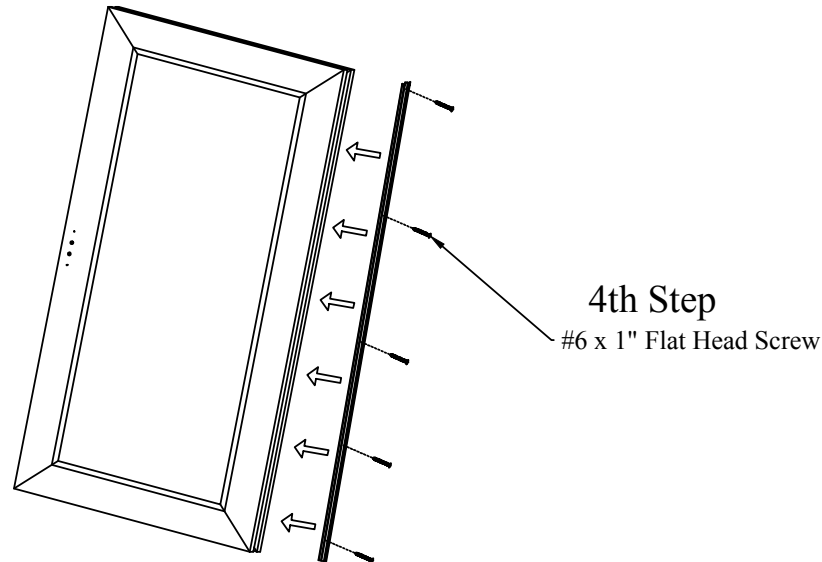

4th ~ Screw and Tape Interlock on to Operating Panel. (Multiple Places)

5th ~ Follow directions below to seat Operating Panel.

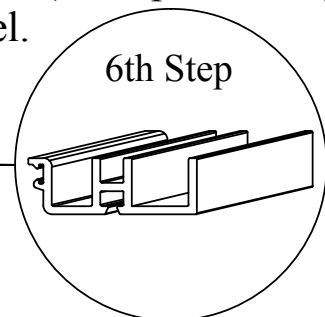
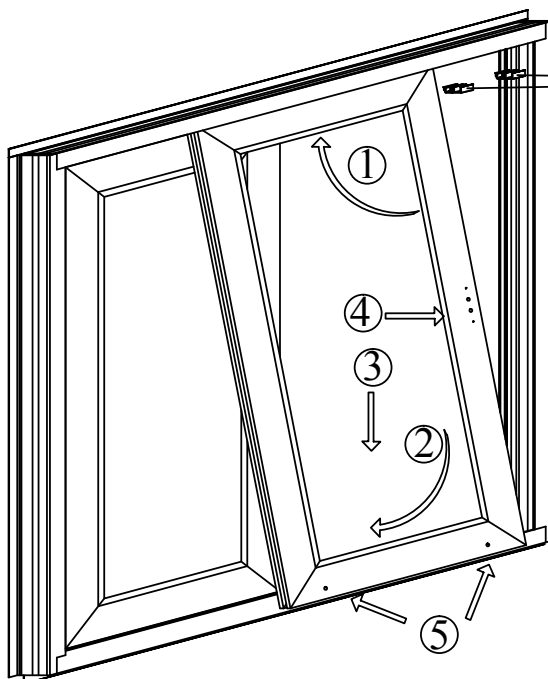

- 5th Step
- ① Lift Operating Panel into Head.
 - ② Swing bottom into Frame.
 - ③ Seat Panel onto Wheels in Sill.
 - ④ Slide Panel firmly into Jamb.
 - ⑤ Adjust Wheel Height & fit Plugs.

6th ~ Snap in Anti - Lift blocks. (Two Places)

7th ~ Attach Keeper to Jamb and Handle to door.
(Using Instructions provided with Hardware Pack.)

